

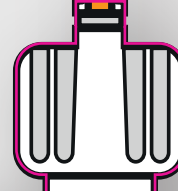

ABBREVIATED PRESCRIBING INFORMATION: Dacepton 5 mg/ml Solution for infusion. **QUALITATIVE AND QUANTITATIVE COMPOSITION:** 1 ml contains 5 mg apomorphine hydrochloride hemihydrate, 20 ml contain 100 mg apomorphine hydrochloride hemihydrate. Excipient with known effect: Sodium metabisulphite (E223) 1 mg per ml, Sodium chloride 8 mg per ml. **PHARMACEUTICAL FORM:** Solution for infusion. Clear and colourless to slightly yellow solution, free from visible particles, pH of 3.3 – 4.0. Osmolality: 290 mOsm/kg. **THERAPEUTIC INDICATIONS:** Treatment of motor fluctuations ("on-off" phenomena) in patients with Parkinson's disease which are not sufficiently controlled by levodopa, with or without dopamine agonists, should be optimised before starting treatment with Dacepton 5 mg/ml solution for infusion. **ADULTS: METHOD OF ADMINISTRATION:** Dacepton 5 mg/ml solution for infusion is a pre-diluted vial intended for use without dilution for subcutaneous use and to be administered as a continuous subcutaneous infusion by minipump and/or syringe-driver. It is not intended to be used for intermittent injection. Apomorphine must not be used via the intravenous route. Do not use if the solution has turned green. The solution should be inspected visually prior to use. Only clear, colourless to slightly yellow and particle free solution should be used. **POSLOGY:** Continuous Infusion Patients who have shown a good "on" period response during the initiation stage of apomorphine therapy, but whose overall control remains unsatisfactory using intermittent injections, or who require many and frequent injections (more than 10 per day), may be commenced on or transferred to continuous subcutaneous infusion by minipump and/or syringe-driver as follows: The choice, of which minipump and / or syringe-driver to use, and the dosage settings required, will be determined by the physician in accordance with the particular needs of the patient. **DETERMINATION OF THRESHOLD DOSE:** The threshold dose for continuous infusion should be determined as follows: Continuous infusion is started at a rate of 1 mg apomorphine hydrochloride hemihydrate (0.2 ml) per hour then increased according to the individual response each day. Increases in the infusion rate should not exceed 0.5 mg at intervals of not less than 4 hours. Hourly infusion rates may range between 1 mg and 4 mg (0.2 ml and 0.8 ml), equivalent to 0.014-0.06 mg/kg/hour. Infusions should run for waking hours only. Unless the patient is experiencing severe night-time problems, 24 hour infusions are not advised. Tolerance to the therapy does not seem to occur as long as there is an overnight period without treatment of at least 4 hours. In any event, the infusion site should be changed every 12 hours. Patients may need to supplement their continuous infusion with intermittent bolus boosts, as necessary, and as directed by their physician. A reduction in dosage of other dopamine agonists may be considered during continuous infusion. **ESTABLISHMENT OF TREATMENT:** Alterations in dosage may be made according to the patient's response. The optimal dosage of apomorphine hydrochloride hemihydrate varies between individuals but, once established, remains relatively constant for each patient. **PRECAUTIONS ON CONTINUING TREATMENT:** The daily dose of Dacepton 5 mg/ml solution for infusion varies widely between patients, typically within the range of 3-30 mg. It is recommended that the total daily dose of apomorphine hydrochloride hemihydrate should not exceed 100 mg. In clinical studies it has usually been possible to make some reduction in the dose of levodopa; this effect varies considerably between patients and needs to be carefully managed by an experienced physician. Once treatment has been established, domperidone therapy may be gradually reduced in some patients but successfully eliminated only in a few, without any vomiting or hypotension. **Paediatric population:** Dacepton 5 mg/ml solution for infusion is contraindicated for children and adolescents under 18 years of age. Elderly: The elderly are well represented in the population of patients with Parkinson's disease and constitute a high proportion of those studied in clinical trials of apomorphine. The management of elderly patients treated with apomorphine has not differed from that of younger patients. However, extra caution is recommended during initiation of therapy in elderly patients because of the risk of postural and orthostatic hypotension. A dose schedule similar to that recommended for adults, and in the elderly, can be followed for patients with renal impairment. **CONTRAINDICATIONS:** Hypersensitivity to the active substance or to any of the excipients. In patients with respiratory depression, dementia, psychotic diseases or hepatic insufficiency. Apomorphine hydrochloride hemihydrate treatment must not be administered to patients who have an "on" response to levodopa which is marred by severe dyskinesia or dystonia. Dacepton 5 mg/ml solution for infusion is contraindicated for children and adolescents under 18 years of age. Special warnings and precautions for use Apomorphine hydrochloride hemihydrate should be given with caution to patients with renal, pulmonary or cardiovascular disease and persons prone to nausea and vomiting. Extra caution is recommended during initiation of therapy in elderly and debilitated patients. Since apomorphine may produce hypotension, even when given with domperidone pre-treatment, care should be exercised in patients with pre-existing cardiac disease or in patients taking vasoactive medicinal products such as antihypertensives, and especially in patients with pre-existing postural hypotension. Since apomorphine, especially at high dose, may have the potential for QT prolongation, caution should be exercised when treating patients at risk for torsades de pointes arrhythmia. Apomorphine is associated with local subcutaneous effects. These can sometimes be reduced by the rotation of injection sites or possibly by the use of ultrasound (if available) prior to avoid areas of induration and induration. Haemolytic anaemia and thrombocytopenia have been reported in patients treated with apomorphine. Haematology tests should be undertaken at regular intervals as with levodopa, when given concomitantly with apomorphine. Caution is advised when combining apomorphine with other medicinal products, especially those with a narrow therapeutic range. Neuropsychiatric problems co-exist in many patients with advanced Parkinson's disease. There is evidence that for some patients neuropsychiatric disturbances may be exacerbated by apomorphine. Special care should be exercised when apomorphine is used in these patients. Apomorphine has been associated with somnolence, sudden sleep onset and sleep disturbance, particularly in patients with Parkinson's disease. Patients must be informed of this and advised to exercise caution while driving or operating machines during treatment with apomorphine. Patients who have experienced somnolence and/or an episode of sudden sleep onset must refrain from driving or operating machines. Furthermore, a reduction of dosage or termination of therapy may be considered. Impulse control disorders: Patients should be regularly monitored for the development of impulse control disorders. Patients and carers should be made aware that behavioural symptoms of impulse control disorders including pathological gambling, increased libido, hypersexuality, compulsive buying, binge eating and compulsive eating can occur during treatment with apomorphine. Dose reduction/tapered discontinuation should be considered if such symptoms develop. Dopamine dysregulation Syndrome (DDS) is an addictive disorder resulting in excessive use of the product seen in some patients treated with apomorphine. Before initiation of treatment, patients and caregivers should be warned of the potential risk of developing DDS. Dacepton 5 mg/ml solution for infusion contains sodium metabisulphite which may rarely cause severe hypersensitivity reactions and bronchospasm. Dacepton 5 mg/ml contains 3.4 mg sodium per ml. To be taken into consideration by patients on a continuous subcutaneous infusion with other medicinal products and other drugs: Patients selected for treatment with apomorphine hydrochloride hemihydrate are almost certain to be taking concomitant medications for their Parkinson's disease. In the initial stages of apomorphine hydrochloride hemihydrate therapy, the patient should be monitored for unusual side-effects or signs of potentiation of effect. Neuroleptic medicinal products may have an antagonistic effect if used with apomorphine. There is a potential interaction between clozapine and apomorphine, however clozapine may also be used to reduce the symptoms of neuropsychiatric complications. If neuroleptic medicinal products have to be used in patients with Parkinson's disease treated by apomorphine agonists, a gradual reduction in apomorphine dose may be considered. Since administration is by minipump and/or syringe-driver (symptoms such as somnolence, sudden sleep onset, and sleep disturbance have been reported rarely with abrupt withdrawal of dopaminergic therapy). The possible effects of apomorphine on the plasma concentrations of other medicinal products have not been studied. Therefore caution is advised when combining apomorphine with other medicinal products, especially those with a narrow therapeutic range. Antihypertensive and Cardiac Active Medicinal Products: Even when co-administered with domperidone, apomorphine may potentiate the antihypertensive effects of these medicinal products. It is recommended to avoid the administration of apomorphine with other drugs known to prolong the QT interval, pregnancy and lactation: There is no experience of apomorphine usage in pregnant women. Animal reproduction studies do not indicate any teratogenic effects, but doses given to rats which are toxic to the mother can lead to failure to breathe in the newborn. The potential risk for humans is unknown. Dacepton 5 mg/ml solution for infusion should not be used during pregnancy unless clearly necessary. It is not known whether apomorphine is excreted in breast milk. A decision on whether to continue/discontinue breastfeeding or to continue/discontinue therapy with Dacepton 5 mg/ml solution for infusion should be made taking into account the benefit of breast-feeding to the child and the benefit of Dacepton 5 mg/ml solution for infusion to the woman. Effects on ability to drive and use machines: Apomorphine hydrochloride hemihydrate has minor effects on influence on the ability to drive and use machines. Patients being treated with apomorphine and presenting with somnolence and/or sudden sleep episodes must be informed to refrain from driving or engaging in activities (e.g. operating machines) where impaired alertness may put themselves or others at risk of serious injury or death until such recurrent episodes and somnolence have resolved. **UNDESIRABLE EFFECTS:** Very common: ($\geq 1/10$), common: ($\geq 1/100$ to $< 1/10$), uncommon: ($\geq 1/1,000$ to $< 1/100$), rare: ($\geq 1/10,000$ to $< 1/1,000$), very rare: ($< 1/10,000$). Not known: (cannot be estimated from the available data). Blood and lymphatic system disorders: Common: Haemolytic anaemia and thrombocytopenia have been reported in patients treated with apomorphine. Rare: Eosinophilia has rarely occurred during treatment with apomorphine hydrochloride hemihydrate. Immune system disorders: Rare: Due to the presence of sodium metabisulphite, allergic reactions (including anaphylaxis and bronchospasm) may occur. Psychiatric disorders: Common: Neuropsychiatric disturbances are common in parkinsonian patients. Dacepton 5 mg/ml solution for infusion should be used with special caution in these patients. Neuropsychiatric disturbances (including transient mild confusion and visual hallucinations) have occurred during apomorphine hydrochloride hemihydrate therapy. Not known: Impulse control disorders: Pathological gambling, increased libido, hypersexuality, compulsive buying, binge eating and compulsive eating can occur during treatment with apomorphine. Aggression, agitation. Nervous system disorders: Common: Transient sedation with each dose of apomorphine hydrochloride hemihydrate at the start of therapy may occur; this usually resolves over the first few weeks. Apomorphine is associated with somnolence. Dizziness / light-headedness have also been reported. Uncommon: Apomorphine may induce dyskinesias during "on" periods which can be severe in some cases, and in a few patients may result in cessation of therapy. Apomorphine has been associated with sudden sleep onset episodes, syncope and headache. Vascular disorders: Uncommon: Postural hypotension is seen infrequently and is usually transient. Respiratory, thoracic and mediastinal disorders Common: Yawning has been reported during apomorphine therapy. Uncommon: Breathing difficulties have been reported. Gastrointestinal disorders: Common: Nausea and vomiting, particularly when apomorphine treatment is first initiated, usually as a result of the omission of domperidone. Skin and subcutaneous tissue disorders: Uncommon: Local and generalised rashes have been reported. eneral disorders and administration site conditions: Very common: Most patients experience injection site reactions, particularly with continuous use. These may include subcutaneous nodules, induration, erythema, tenderness and panniculitis. Various other local reactions (such as irritation, itching, bruising and pain) may also occur. Uncommon: Injection site necrosis and ulceration have been reported. Not Known: Peripheral oedema has been reported. Investigations Uncommon: Positive Coombs' tests have been reported for patients receiving apomorphine. Reporting of suspected adverse reactions Reporting suspected adverse reactions after authorisation of the medicinal product is important. It allows continued monitoring of the benefit/risk balance of the medicinal product. Healthcare professionals are asked to report any suspected adverse reactions via the national reporting system. Overdose: There is little clinical experience of overdose with apomorphine by this route of administration. Symptoms of overdose may be treated empirically as suggested: Excessive emesis may be treated with domperidone. Respiratory depression may be treated with naloxone. Hypotension: appropriate measures should be taken, e.g. raising the foot of the bed. Bradycardia may be treated with atropine. **PHARMACODYNAMIC PROPERTIES:** Pharmacotherapeutic group: Anti-Parkinson drugs, dopamine agonists, ATC code: N04B C07. Mechanism of action: Apomorphine is a direct stimulant of dopamine receptors and while possessing both D1 and D2 receptor agonist properties does not share transport or metabolic pathways with levodopa. Although in intact experimental animals, administration of apomorphine suppresses the rate of firing of nigro-striatal cells and in low dose has been found to produce a reduction in locomotor activity (thought to represent pre-synaptic inhibition of endogenous dopamine release) its actions on parkinsonian motor disability are likely to be mediated at post-synaptic receptor sites. This biphasic effect is also seen in humans. Pharmacokinetic properties: After subcutaneous injection of apomorphine its fate can be described by a two-compartment model, with a distribution half-life of 5 (± 1) minutes and an elimination half-life of 33 (± 3.9) minutes. Clinical response correlates well with levels of apomorphine in the cerebrospinal fluid; the active substance distribution being best described by a two-compartment model. Apomorphine is rapidly and completely absorbed from subcutaneous tissue, correlating with the rapid onset of clinical effects (4-12 minutes), and that the brief duration of clinical action of the active substance (about 1 hour) is explained by its rapid clearance. The metabolism of apomorphine is by glucuronidation and sulphonation to at least ten per cent of the total; other pathways have not been described. **PRECLINICAL SAFETY DATA:** Repeat dose subcutaneous toxicity studies reveal no special hazard for humans, beyond the information included in other sections of the SmPC. In vitro genotoxicity studies demonstrated mutagenic and clastogenic effects, most likely due to products formed by oxidation of apomorphine. However, apomorphine was not genotoxic in the in vivo studies performed. The effect of apomorphine on reproduction has been investigated in rats. Apomorphine was not teratogenic in this species, but it was noted that doses which are toxic to the mother can cause loss of maternal care and failure to breathe in the newborn. No carcinogenicity studies have been performed. **LIST OF EXCIPIENTS:** Sodium metabisulphite (E223), Sodium chloride, Hydrochloric acid (for pH-adjustment), water for injections: Incompatibilities: In the absence of compatibility studies, this medicinal product must not be mixed with other medicinal products. **SHELF LIFE:** Unopened: 30 months. After opening and filling the drug product in syringes attached with infusion sets: chemical and physical in-use stability has been demonstrated for 7 days at 25 °C. From a microbiological point of view, unless the method of opening and further handling precludes the risk of microbial contamination, the product should be used immediately. If not used immediately, in-use storage times and conditions are the responsibility of the user. Single use only. Discard any unused contents. Special precautions for storage: Keep the vials in the outer carton in order to protect from light. Do not refrigerate or freeze. **NATURE AND CONTENTS OF CONTAINER:** Clear glass vials, type I with bromobutyl rubber stopper and a flip-off cap, containing 20 ml solution for infusion, in packs of 1 or 5 vials. Bundle packs: 5 x 1, 10 x 1, 30 x 1, 2 x 5 and 6 x 5. Not all pack sizes may be marketed. Special precautions for handling and other handling: Do not use if the solution has turned green. The solution should be inspected visually prior to use. Only clear and colourless to slightly yellow solutions without particles in undamaged containers should be used. For single use only. Any unused medicinal product or waste material should be disposed in accordance with local requirements. Continuous infusion and the use of a minipump and/or syringe-driver The choice of which minipump and/or syringe-driver to use, and the dosage settings required, will be determined by the physician in accordance with the particular needs of the patient. **MARKETING AUTHORISATION HOLDER:** EVER Neuro Pharma GmbH, Oberburgau 3, 4866 Unterach, Österreich. **MARKETING AUTHORISATION NUMBER:** ATH/0364/002/DC. Legal Category: POM. Date of last revision: July 2020.



D-mine® Pump



SO EASY

The new D-mine® Pump for Dacepton® 5 mg/ml infusions in Parkinson's disease

NEW

EVER Pharma GmbH
Oberburgau 3, 4866 Unterach/Austria
www.everpharma.com

DAC/INT/03/2021/05
D-mine_PumpSalesAd_V02



SUBCUTANEOUS USE

Dacepton®
Apomorphine Hydrochloride

THE ONLY MG-BASED VOLUMETRIC PUMP SYSTEM.

**Specifically developed for
patients with Parkinson's Disease**

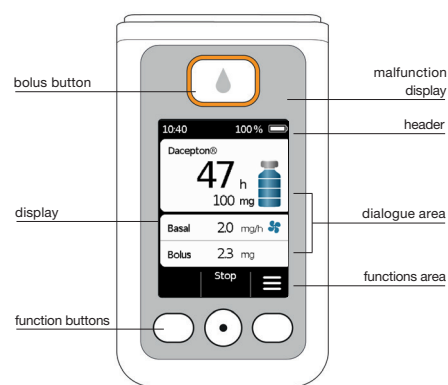

- mg-based for less dose errors
- automatic filling process for less handling steps and more safety
- individually programmable with 5 rates
- intuitive menu guidance in local language
- electronic filling control
- less time required for training
- data history

INTUITIVE HANDLING MAKES LIFE EASY.

**Easy handling in just 5 steps for
more self-autonomy**



Step 1: Preparing

Take the sterile D-mine[®] Pump reservoir out of the blister and connect it with the pump.

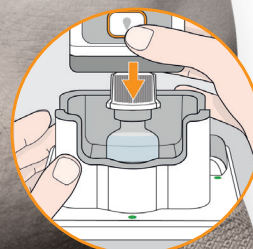

Step 2: Attaching

Fix the entire pump with the reservoir and attached adapter onto the vial.



Step 3: Filling

Put the pump in the docking station and start the filling process.

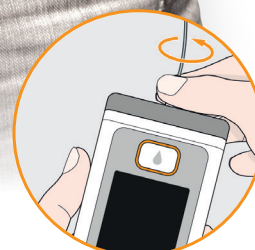

Step 4: Connecting

Connect the infusion set to the pump.

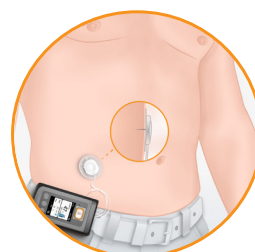

Step 5: Starting

After the priming process puncture the skin and start the infusion.

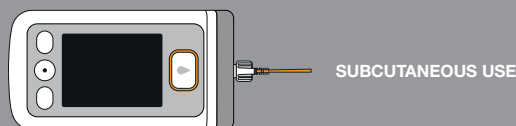

Dacepton[®]
Apomorphine Hydrochloride